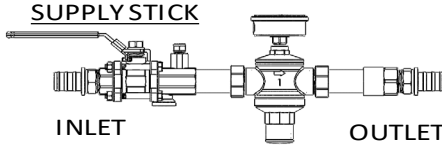
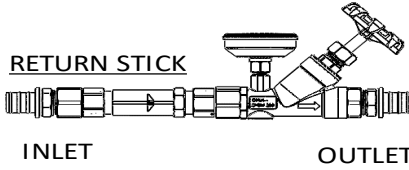

PCW STICK PART NUMBER MATRIX <sup>1</sup>	
W S - 08 M 08 M - 2 D 5 G - B	
<p><b>W = Water Stick</b></p> <hr/> <p><b>Type</b></p> <p><b>S = Supply Stick</b> R = Return Stick</p> <hr/> <p><b>Inlet Size</b></p> <p>04 = 1/4" 06 = 3/8" <b>08 = 1/2"</b> 12 = 3/4" 16 = 1" 24 = 1-1/2" 32 = 2"</p> <hr/> <p><b>Inlet Connection</b></p> <p>C = Compression E = Extended Hose Barb F = Female NPT G = Flange H = Hose Barb <b>M = Male NPT</b> N = Extended Male NPT U = Extended Union V <sup>2</sup> = Extended Union (Compact) Y = Union Z <sup>2</sup> = Union (Compact)</p> <hr/> <p><b>Outlet Size</b></p> <p>04 = 1/4" 06 = 3/8" <b>08 = 1/2"</b> 12 = 3/4" 16 = 1" 24 = 1-1/2" 32 = 2"</p> <hr/> <p><b>Outlet Connection</b></p> <p>C = Compression E = Extended Hose Barb F = Female NPT G = Flange H = Hose Barb <b>M = Male NPT</b> N = Extended Male NPT U = Extended Union V <sup>2</sup> = Extended Union (Compact) Y = Union Z <sup>2</sup> = Union (Compact)</p>	<hr/> <p><b>Flow Meter Range</b></p> <p>A = 1 GPM <b>B = 5 GPM</b> C = 16 GPM D = 28 GPM E = 100 GPM F = 50 GPM X = Not Required</p> <hr/> <p><b>Outlet Item Options</b></p> <p>P = Petes Plug<sup>®</sup> <b>G = Pressure Gauge</b> D = Dual Pressure / Temperature Gauge X = Not Required</p> <hr/> <p><b>Outlet Item</b></p> <p>X = Not Required <b>Supply Stick Only</b> <b>5 = Regulator</b> 6 = Regulator (180° Orientation) <b>Return Stick Only</b> 4 = Globe Valve</p> <hr/> <p><b>Inlet Item Options</b></p> <p>P = Petes Plug<sup>®</sup> G = Pressure Gauge <b>D = Dual Pressure / Temperature Gauge</b> X = Not Required</p> <hr/> <p><b>Inlet Item</b></p> <p>X = Not Required <b>Supply Stick Only</b> 1 = Ball Valve (Oval Handle) <b>2 = Ball Valve (Lever)</b> <b>Return Stick Only</b> 3 = Flowmeter</p>
 <p><b>SUPPLY STICK</b></p> <p>INLET                      OUTLET</p>  <p><b>RETURN STICK</b></p> <p>INLET                      OUTLET</p>	
<p>Notes:</p> <p><sup>1</sup> Not all possible part number configurations are available. Please contact Valex for availability.</p> <p><sup>2</sup> Used only for 1.5" and 2" union sizes that also have stainless steel mating end connection.</p>	

## PCW UNION FITTING PART NUMBER MATRIX <sup>1</sup>

**WU- U - 16 P - 16 M**

**Product Line**

WU = PCW Unions

**Union Type**

U = Standard  
V<sup>2</sup> = Compact

**"Flat" Size**

XX = None  
04 = 1/4  
06 = 3/8  
08 = 1/2  
12 = 3/4  
**16 = 1**  
24 = 1-1/2  
32 = 2

**"Flat" Side Assembly**

X = None (No Flat Side)  
**P = PVC I**  
C = CPVC  
H = Hose Barb  
S = NPS Pipe  
T = Tube

**"Thread" Side Assembly**

X<sup>3</sup> = None (No Thread Side, No Hex Nut)  
**M = Male NPT**  
S = NPS Pipe  
T = Tube

**"Thread" Size**

XX = None  
04 = 1/4  
06 = 3/8  
08 = 1/2  
12 = 3/4  
**16 = 1**  
24 = 1-1/2  
32 = 2

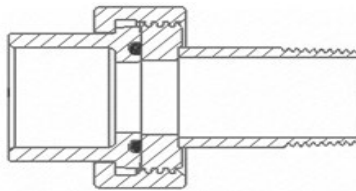

PVC I, CPVC,  
Hose Barb,  
Pipe or Tube

O-RING

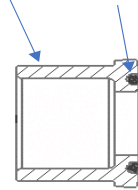

"FLAT" SIDE

HEX NUT



"THREAD" SIDE

Male NPT,  
Pipe or Tube

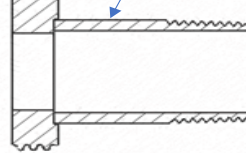

<sup>1</sup> Not all possible part number configurations are available. Please contact Valex for availability.

<sup>2</sup> Compact Union Type: used only for stainless steel "Flat" assembly end connection options.

<sup>3</sup> No thread side, no hex nut option: used on PCW sticks which already contain compatible mating ends.